

MOUNTING DIM'S
ON CONCRETE
BASE PAD

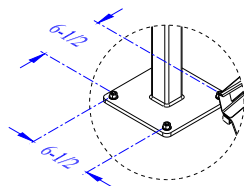

View A
3:1

See View A

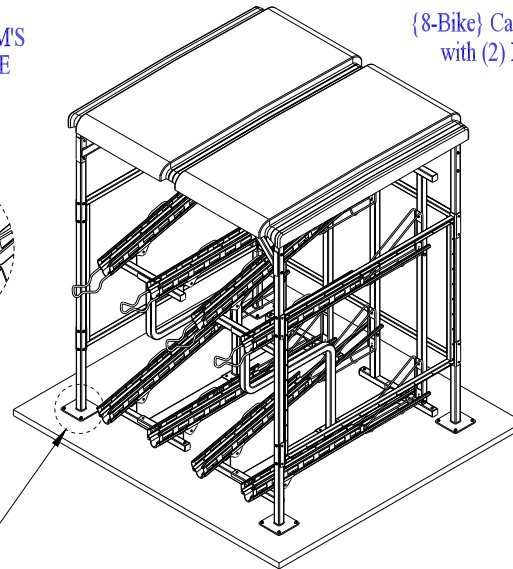

{8-Bike} Capacity Shelter
with (2) HD-Racks

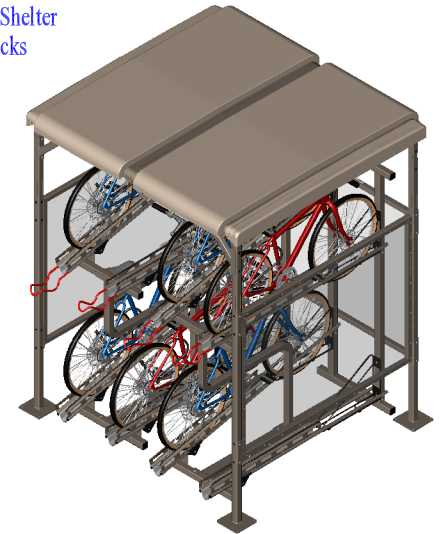

SHELTER CONTRUCTION IS COMPRESSION MOLDED SMC
FIBERGLASS TOPS WITH ABS SOFFETS, POWDER COATED
STEEL FRAMES & POLYCARBONITE SIDE PANELS

STANDARD COLORS ARE TAUPE FRAMES & SANDSTONE
TOPS & SOFFETS. OTHER COLORS AVAILABLE

SHELTERS ARE AVAILABLE IN (2) TOP & (3) TOP STARTERS
WITH ADDITIONAL (2) TOP & (3) TOP ADDERS COMBINED
TO CREATE UP TO A (24) TOP SHELTER BANK

(2) HD-RACKS HAVE TUBULAR STEEL POWDER COATED
FRAMES WITH 3/8" Ø POWDER COATED STEEL ROD
WALL-RACKS & PVC WHEEL GUIDES

STAINLESS STEEL WALL-RACKS ARE ALSO AVAILABLE

SHIPPING WEIGHT IS 1135 LBS. OR 515 KG.

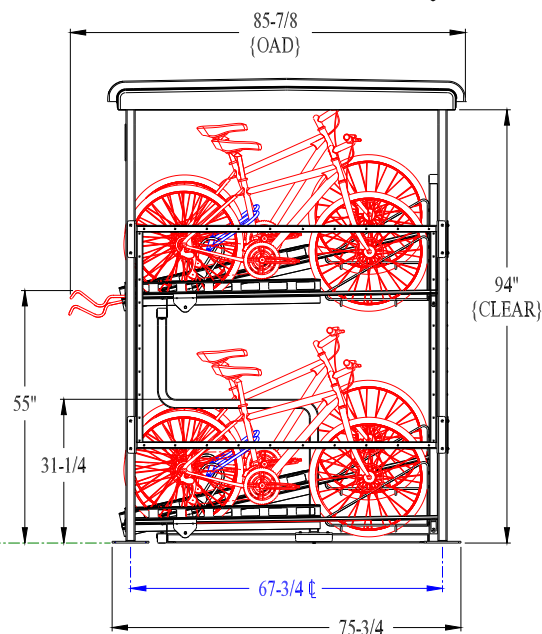
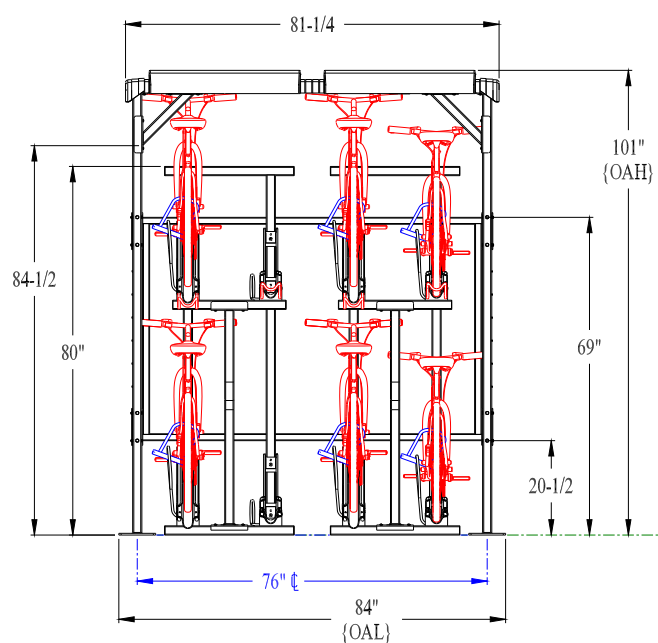

SHEET 1 OF 1	A	RELEASE FOR QUOTE		10/20/18
	REV	DESCRIPTION		DATE
TOLERANCES UNLESS OTHERWISE SPECIFIED: +/-	CYCLEPORT {2-TOP} ASSEMBLY {D-SHELTER}			
	BOB SLYH		10/23/18	Cycle Safe 5211 CASCADE ROAD - SUITE 210 GRAND RAPIDS, MI 49546 www.cyclesafe.com
	CHECKED		DATE	
	APPROVED		DATE	
	.X .030	SIZE D	{3-SIDE} POLYCARBONITE (HD-RACKS)	
.XX .010				
.XXX .005				
ANGLE 1/2"				